

MATERIAL:

- 1.1 Insulator: P.B.T /UL 94V-0 Rated. Color Blue /White /Black.
- 1.2 Contact: Copper Alloy /t=0.20mm.
- 1.3 Shell: Cold Rolled /t=0.35mm Tin Plated.
- 1.4 Contact: Gold Flashed 1u",3u",5u",10u",15u",30u".

SPECIFICATIONS:

- 2.1 Current Rating: 1 A Max.
- 2.2 Dielectric Withstanding Voltage: 500 V(ac) For 1 Min.
- 2.3 Contact Resistance: 30 mΩ Max.
- 2.4 Insulation Resistance: DC 500V下1000 MΩ Min.
- 2.5 Temperature Range:Ω -55°C ~ + 105°C.

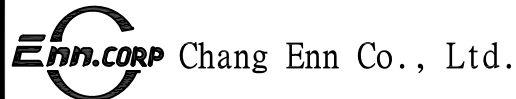
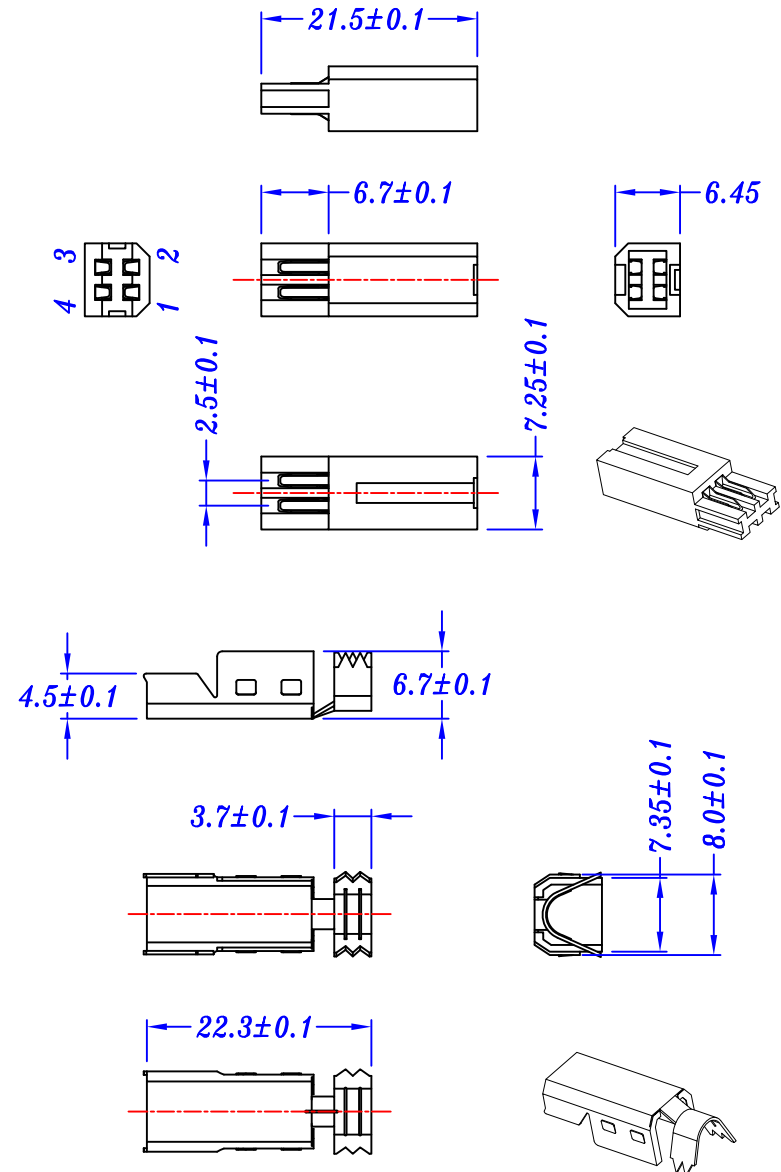
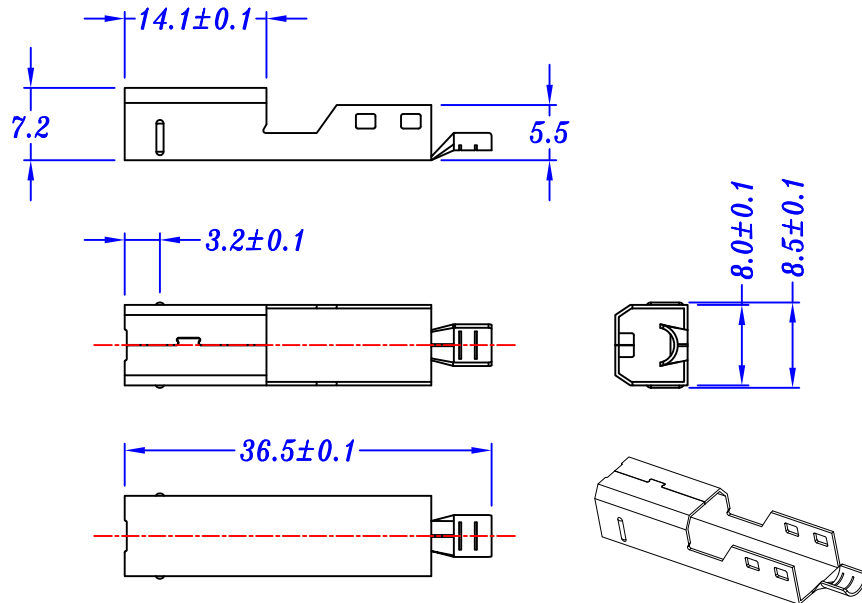

NO.410, FU-TEH 1ST ROAD, SHIJR, TAIPEI COUNTY 221, TAIWAN, R.O.C. TEL: 886-2-26945824 FAX: 886-2-26946971	TITLE	SUB 2.0-B TYPE Solder (Male)三件式		GENERAL TOLERANCE	DRAWN	DATE	103/07/16	
	PARTS NO.	PND15-SBP		DIM: X. ±0.30 X.X ±0.20 X.XX±0.10	CHECK	DATE		
	DWG, NO.				APPROVE	DATE		
					SCALE	FREE	UNIT	MM