

Plug Contact

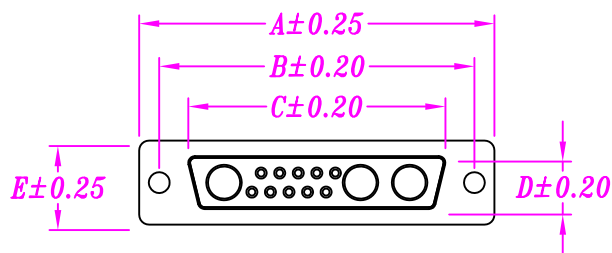

Receptacle Contact

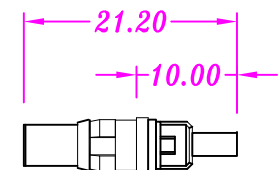

Receptacle Contact

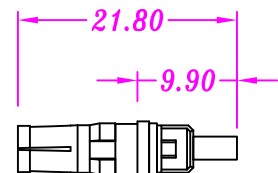
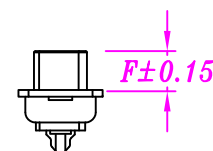
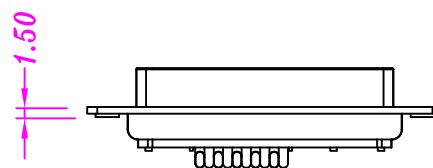
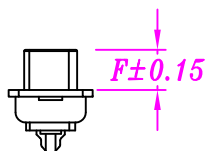
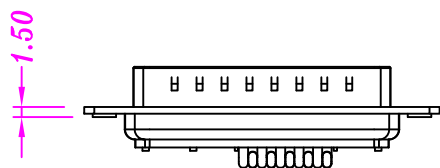

Plug Contact

Shell Size	Series NO	Connector Type	Contact Type	Impedance R.G Cable	Dimension					
					A±0.25	B±0.20	C±0.20	D±0.20	E±0.25	F±0.15
09P	1W1/2W2/5W1	Plug	Solder Cup	75Ω 179B/U	30.81	24.99	16.92	8.38	12.55	6.00
		Receptacle			30.81	24.99	16.33	7.90	12.55	5.80
15P	3W3/7W2/11W1	Plug			39.25	33.32	25.25	8.38	12.55	6.00
		Receptacle			39.25	33.32	24.66	7.90	12.55	5.80
25P	5W5/9W4/13W3 17W2/21W1	Plug			53.04	47.04	38.96	8.38	12.55	6.00
		Receptacle			53.04	47.04	38.38	7.90	12.55	5.80
37P	8W8/13W6/17W5 21W4/25W3/27W2	Plug		69.50	63.50	55.42	8.38	12.55	6.00	
		Receptacle		69.50	63.50	54.84	7.90	12.55	5.80	
50P	24W7/36W4/43W2	Plug		67.10	61.10	54.30	12.20	15.40	6.00	
		Receptacle		67.10	61.10	52.30	10.80	15.40	5.80	

- (1) Pro-loaded stamped single contact.
- (2) Can be mated coaxial or high power contact.
- (3) High power contact available for crimp or solder type in 20A, 40A.
- (4) Metal shell with ground indents.
- (5) Portions riveted hex units or hard ware accessories available.
- (6) Coaxial Contact 50 Ohm, 75 Ohm.

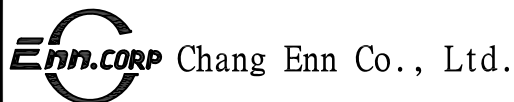

NO.410, FU-TEH 1ST ROAD,
SHIJR, TAIPEI COUNTY
221, TAIWAN, R.O.C.

TEL: 886-2-26945824

FAX: 886-2-26946971

TITLE

Coaxial Contact
for Combination D-Sub

PARTS NO.

PND20-09~50P

DWG, NO.

GENERAL
TOLERANCE

DIM:
X. ±0.30
X.X ±0.20
X.XX ±0.10

DRAWN

CHECK

APPROVE

SCALE

DATE 103/10/30

DATE 103/12/14

DATE

UNIT MM REV. B

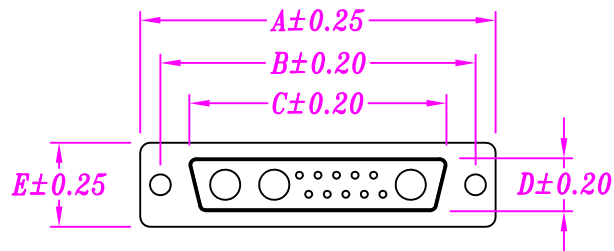

Plug Contact

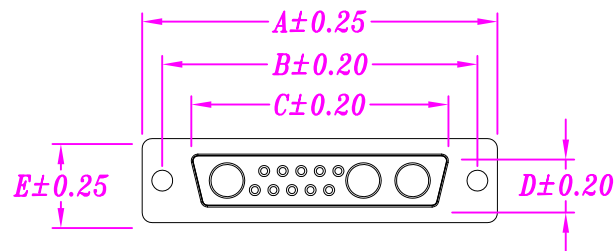

Receptacle Contact

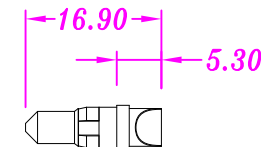

Plug Contact

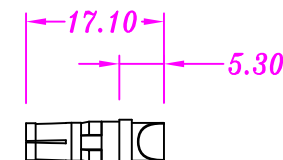
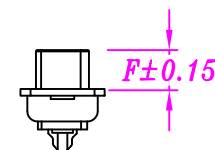
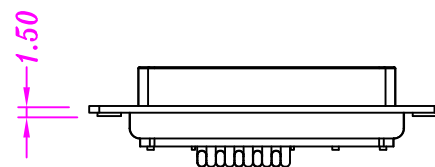
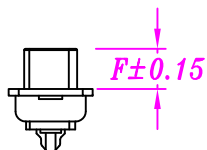
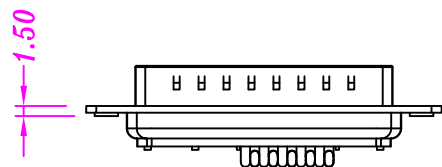

Receptacle Contact

Shell Size	Series NO	Connector Type	Contact Type	Current Rating	Wire Size	Dimension					
						A±0.25	B±0.20	C±0.20	D±0.20	E±0.25	F±0.15
09P	1W1/2W2/5W1	Plug	Solder Cup	40A	#8~#10 AWG	30.81	24.99	16.92	8.38	12.55	6.00
		Receptacle				30.81	24.99	16.33	7.90	12.55	5.80
15P	3W3/7W2/11W1	Plug				39.25	33.32	25.25	8.38	12.55	6.00
		Receptacle				39.25	33.32	24.66	7.90	12.55	5.80
25P	5W5/9W4/13W3 17W2/21W1	Plug				53.04	47.04	38.96	8.38	12.55	6.00
		Receptacle				53.04	47.04	38.38	7.90	12.55	5.80
37P	8W8/13W6/17W5 21W4/25W3/27W2	Plug				69.50	63.50	55.42	8.38	12.55	6.00
		Receptacle				69.50	63.50	54.84	7.90	12.55	5.80
50P	24W7/36W4/43W2	Plug				67.10	61.10	54.30	12.20	15.40	6.00
		Receptacle				67.10	61.10	52.30	10.80	15.40	5.80

- (1) Pro-loaded stamped single contact.
- (2) Can be mated coaxial or high power contact.
- (3) High power contact available for crimp or solder type in 10A, 20A, 30A, 40A.
- (4) Metal shell with ground indents.
- (5) Potions riveted hex units or hard ware accessories available.

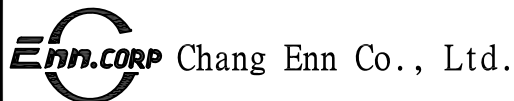

NO.410, FU-TEH 1ST ROAD,
SHIJR, TAIPEI COUNTY
221, TAIWAN, R.O.C.

TEL: 886-2-26945824

FAX: 886-2-26946971

TITLE

High Power Contact
for Combination D-Sub

PARTS NO.

PND20-09~50P

DWG, NO.

GENERAL TOLERANCE

DIM:
X. ±0.30
X.X ±0.20
X.XX±0.10

DRAWN

CHECK

APPROVE

SCALE

DATE 103/10/30

DATE 103/12/14

DATE

UNIT MM REV. B

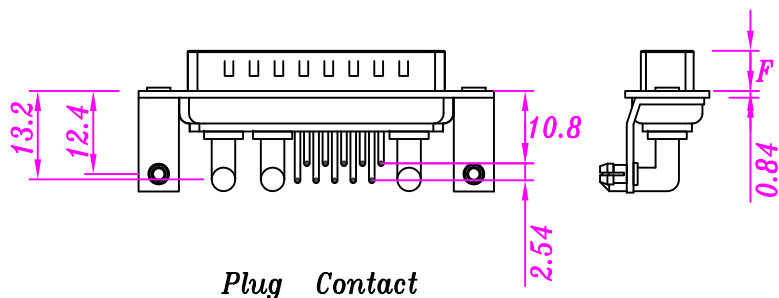
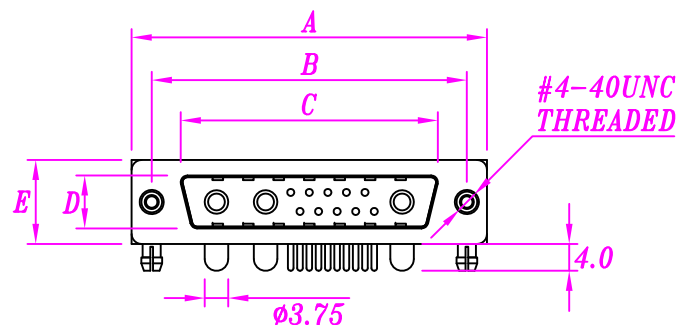

Plug Contact

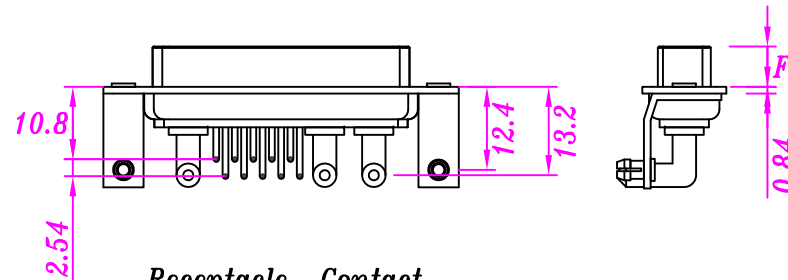
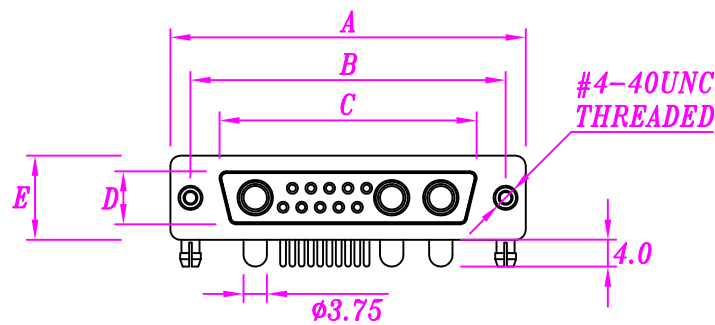

Receptacle Contact

Shell Size	Series NO	Connector Type	Dimension					
			A±0.25	B±0.20	C±0.20	D±0.20	E±0.25	F±0.15
15P	3W3, 7W2, 11W1	PLUG	39.25	33.32	25.25	8.3	12.5	6.0
		Receptacle	39.25	33.32	24.60	7.9	12.5	5.8
25P	5W5, 13W3, 17W2	PLUG	53.04	47.04	38.96	8.3	12.5	6.0
		Receptacle	53.04	47.04	38.30	7.9	12.5	5.8
37P	8W8, 21W4, 25W3	PLUG	69.4	63.5	55.42	8.3	12.5	6.0
		Receptacle	69.4	63.5	54.80	7.9	12.5	5.8

- (1) Standard with #4-40 UNC threaded ground tabs and board locks to secure connector on board.
- (2) Combined with machined signal and 40A high power contacts.
- (3) For side entry connection.
- (4) Metal shell with ground indents.
- (5) Potions riveted hex nuts or hard ware accessories available.